

ASSA ABLOY

ACOUSTIC DOOR

4 hr fire rated, 33 Rw, Single leaf, Acoustic / Smoke / Fire doorset

DESCRIPTION

Pyropanel AS-33-FRB is a 33 Rw, 4 hour fire rated 48mm nominal single leaf acoustic doorset that utilises a approved concealed or surface mounted perimeter seal and an approved bottom seal.

APPLICATIONS

Ideal for applications that require 4 hours of fire resistance and an acoustic rating of 33 Rw, such as warehouses, factories and fire escapes.

FEATURES

Acoustic Rating

- 33 Rw.

Fire Resistance

- FRL -/240/30

Smoke Resistance

- Meets the NCC requirement for a smoke door

Door Configuration

- Single leaf, hung in a steel frame.

Thickness

- 50mm (nominal)

Door Weight

- Approx 39 kg/m²

Size

- Maximum size - 3000 x 1500mm

Frame

- Pyropanel steel frame (filled)

Finish

- Steel as standard

Seal Combinations

Door Type	Perimeter	Bottom	Rw
AS-33-FRB-A	Pyropanel Euroseal	Lorient LAS 8001si	33

OPTIONAL EXTRAS

- Pre-hung in steel frame.
- Vision panels - 300 x 200 or 600 x 100mm nom.
- Kick Panels of 1mm Stainless Steel to selected height.

INSTALLATION

Door frame must be tightly sealed against wall structure using Pyropanel Pyropanel fire and acoustic sealant. Steel door frames will require filling with fire rated plasterboard, Pyropanel light weight M4 mortar, concrete or mortar to achieve desired acoustic and fire rating.

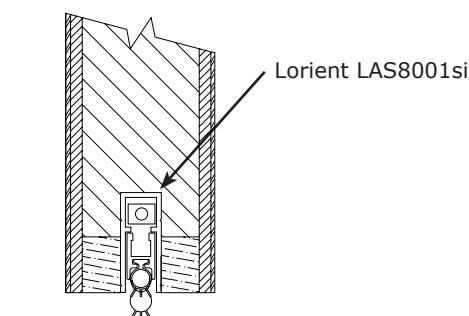
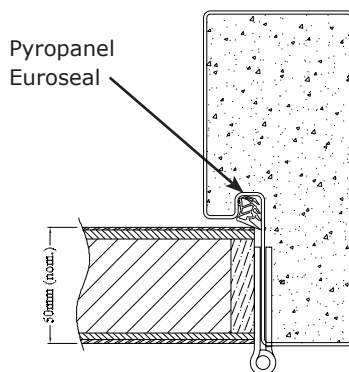

HOW TO SPECIFY

"Door to be a Pyropanel AS-33-FRB-A* acoustic door with -/240/30* FRL, installed into a filled steel door frame"

* denotes example - delete, change or specify as required.

Pyropanel Developments Pty Ltd
235 Huntingdale Rd, Oakleigh, Vic 3166
Ph: **(03) 9837 8500** Fax: (03) 9837 8550
Email: **sales@pyropanel.com.au**
Web: **www.pyropanel.com.au**

Distributed by:
Nexdor Systems
Ph: **(03) 5450 3457**
Email: **estimating@nexdorsystems.com.au**
Web: **www.nexdorsystems.com.au**



Pyropanel Developments has a policy of continuous improvement and reserves the right to change methods and specifications without notice.
Note: The Tech Sheet is an uncontrolled document, If printed please refer to the Tech-Sheet on the website to check if this document is valid.